

EHVT-50 Urine Test Procedure

1. Wear gloves before testing.
2. Hold NFC card to the NFC card reading area for 3 seconds to register consumable data.

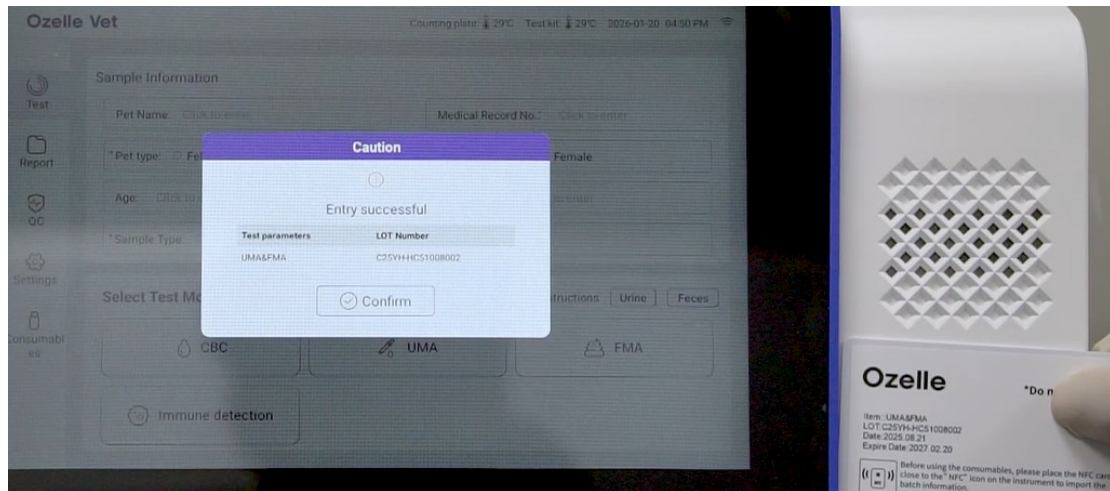

3. Click "Consumables" to check corresponding consumable data.
4. View Operation Guide and the Sample Pre-processing Instruction on the instrument first carefully.

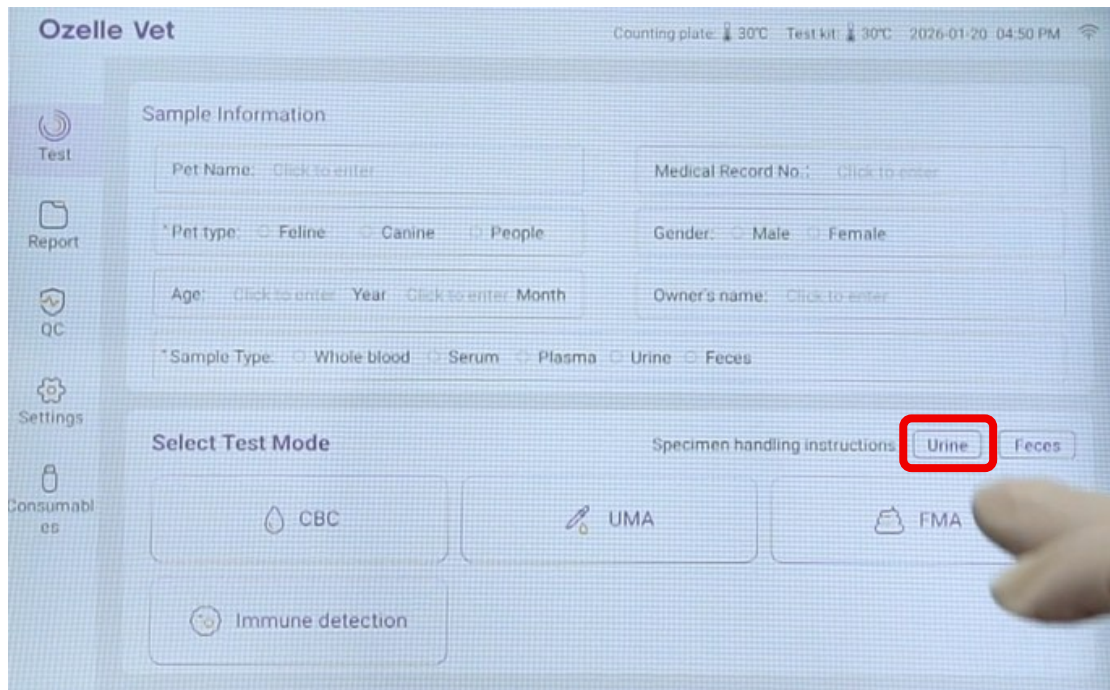

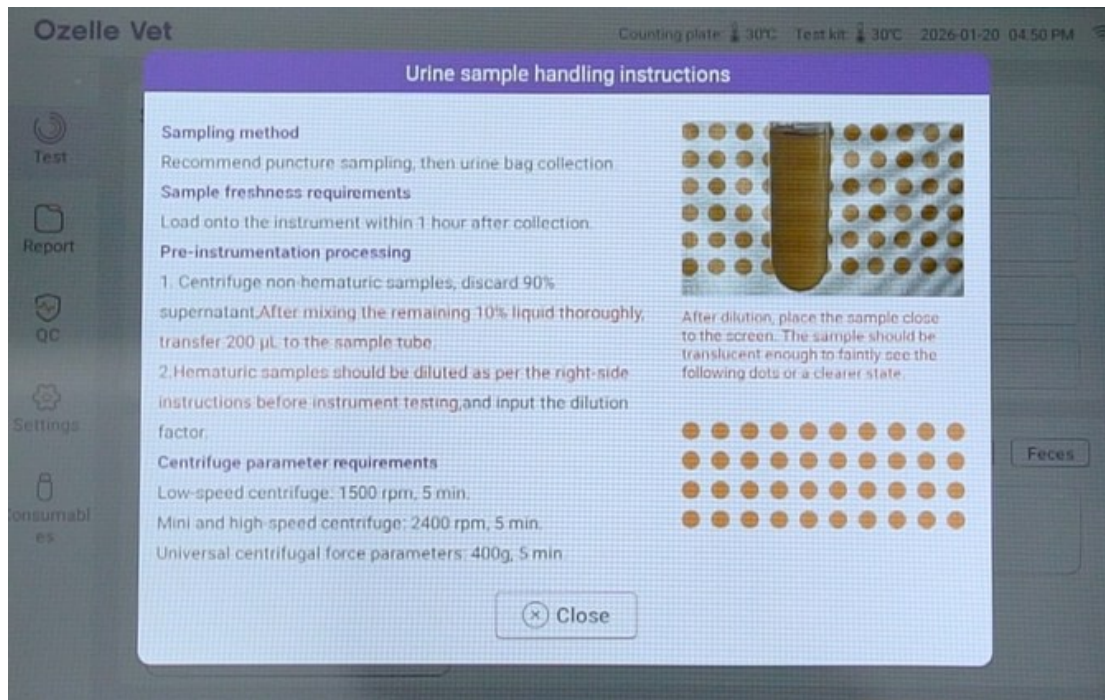

5. Prepare all the consumables.

Prepare the consumables and reagents according to the Operation Guide.

Consumables required per test: Counting Chamber*1, Combined Reagent Kit*1, Tips*2, EP Tube*1.

In addition to the consumables, the following materials must be prepared separately: Disposable medical gloves, centrifuge and centrifuge tubes, pipette, and sterile saline (0.9% NaCl).

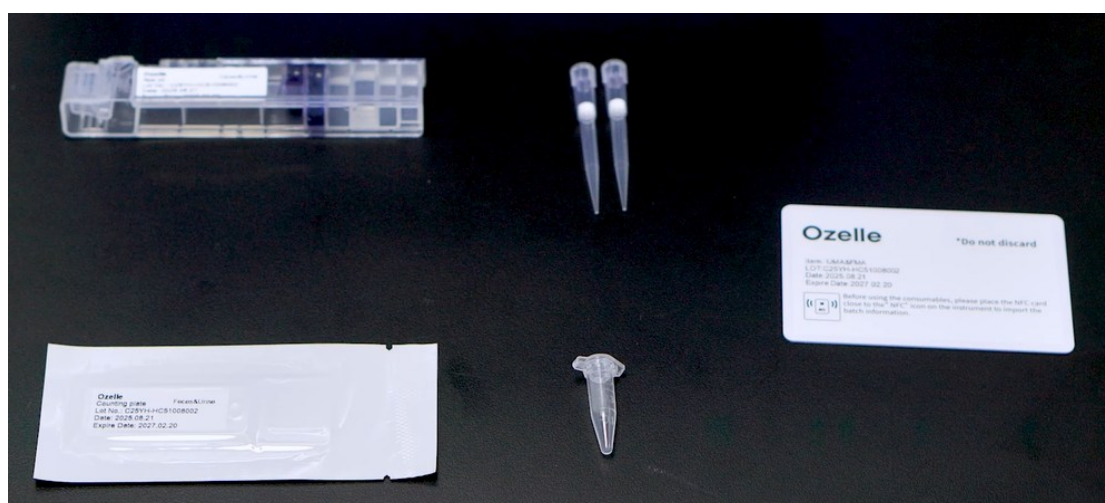

6. Sample Pre-processing

Urine testing supports two types of samples: Non-hematuria and hematuria urine sample.



6.1 Non-hematuria sample

For non-hematuria urine sample, centrifugation is required according to the Pre-processing Instruction.

Use a centrifuge tube to collect at least 2ml of non-hematuria urine sample and centrifuge it.

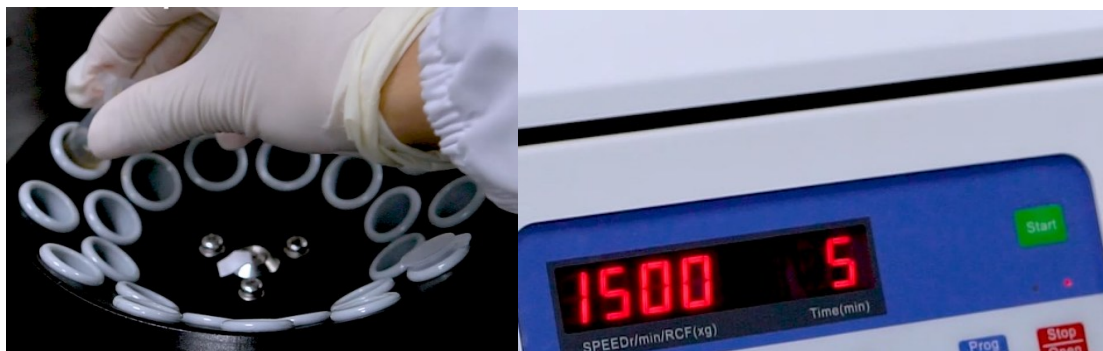

Notice: The choice of centrifuge must follow the Pre-processing Instruction to avoid damaging the formed elements in the sample.

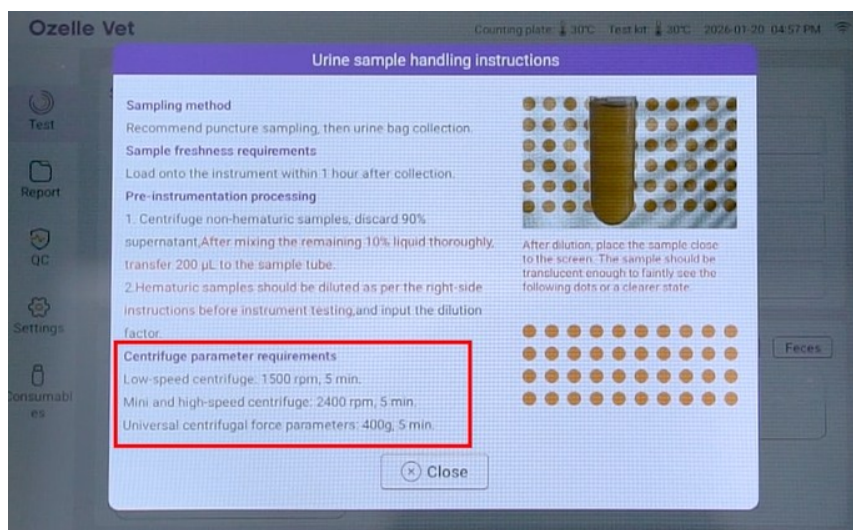

After centrifugation, open the lid and gently take out the sample.

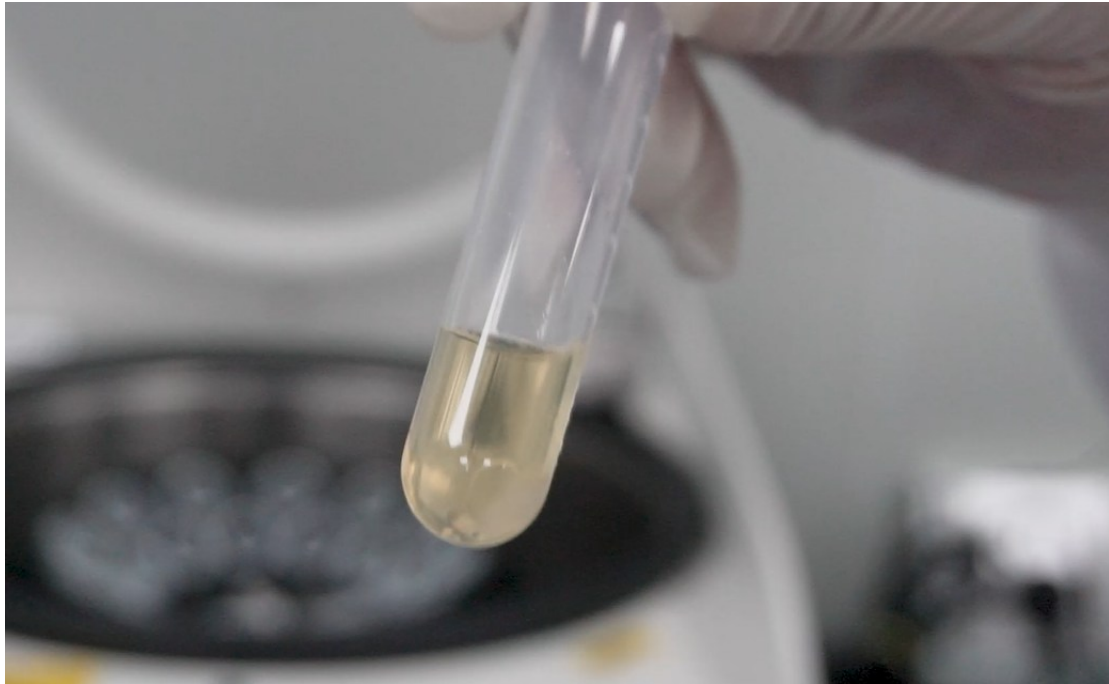

First, use pipette to remove 1 ml of supernatant.

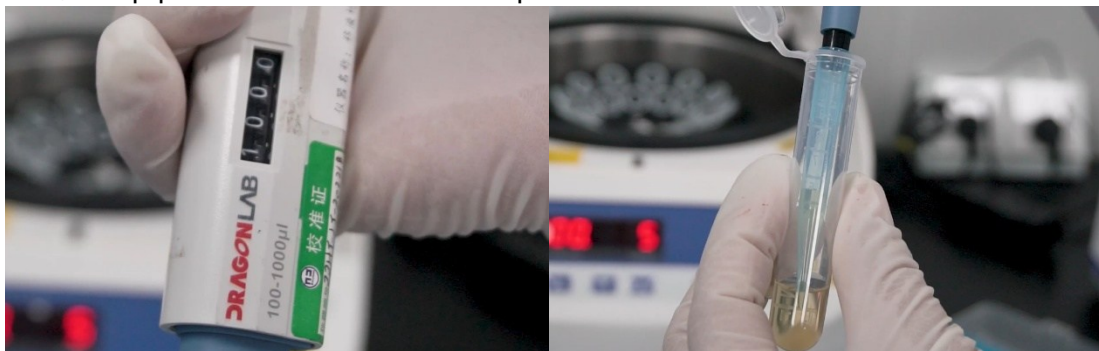

Then adjust pipette volume to remove 0.8 ml of supernatant, note to separate slowly without disturbing the bottom sediment.

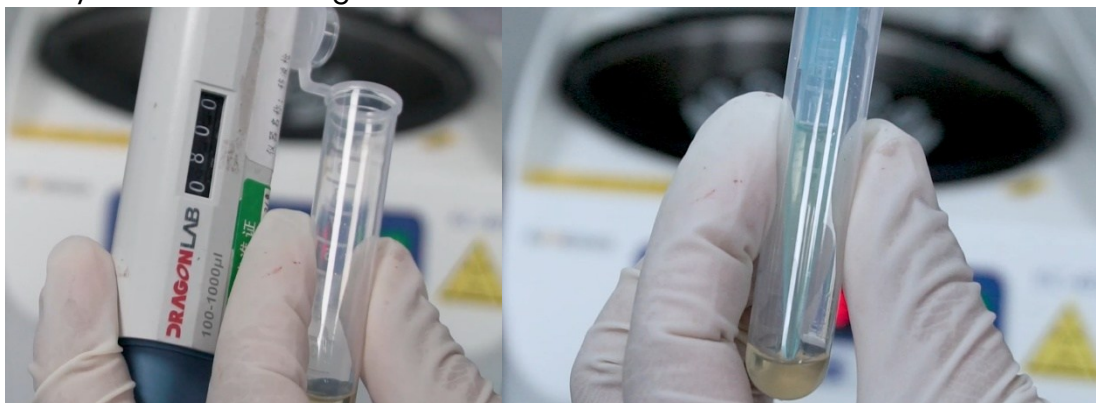

Leave 10% of the sample and gently shake to make it eveny.



6.2 Hematuria Sample

Hematuria samples should be diluted as per the instructions before instrument testing, and input the dilution factor.

Instruction: After dilution, place the sample close to the screen. The sample should be translucent enough to faintly see the following dots or a clearer state.



7. Sample loading

Input the sample information and make sure the species and sample types are correct. Then click the “UMA” button of the test mode.

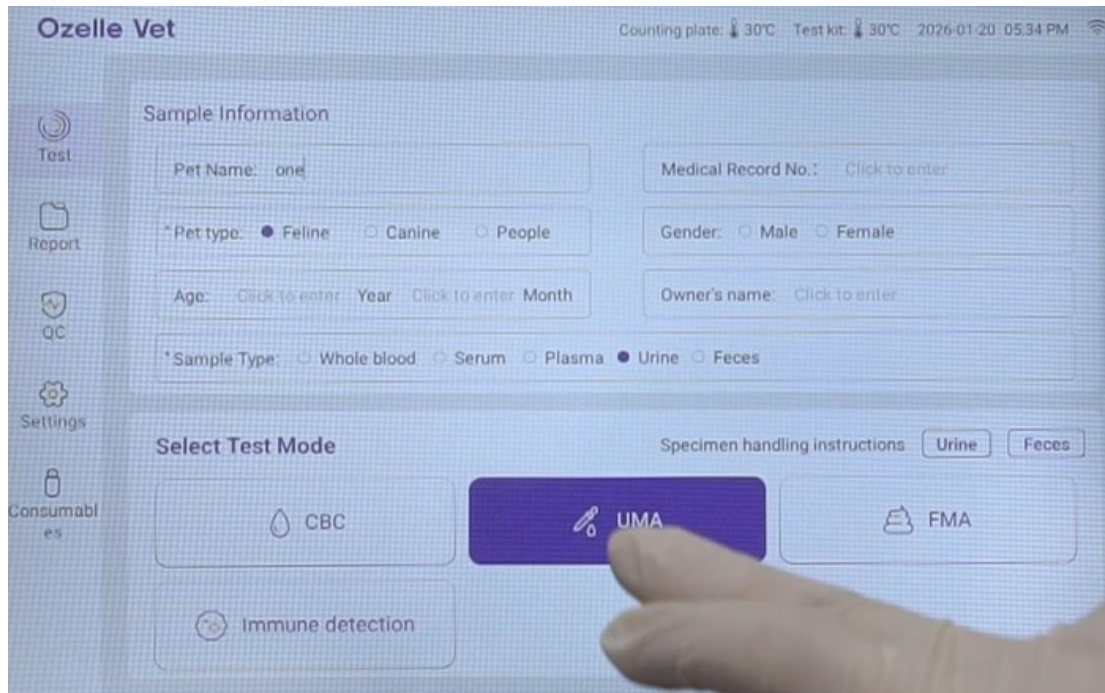

Select the processing method according to the sample type. For non-hematuria urine sample, click “Centrifuge”. For hematuria sample, click “Dilute” and input the dilution factor. Then choose the color and turbidity information of the sample. Click “OK” to the operation guide page.

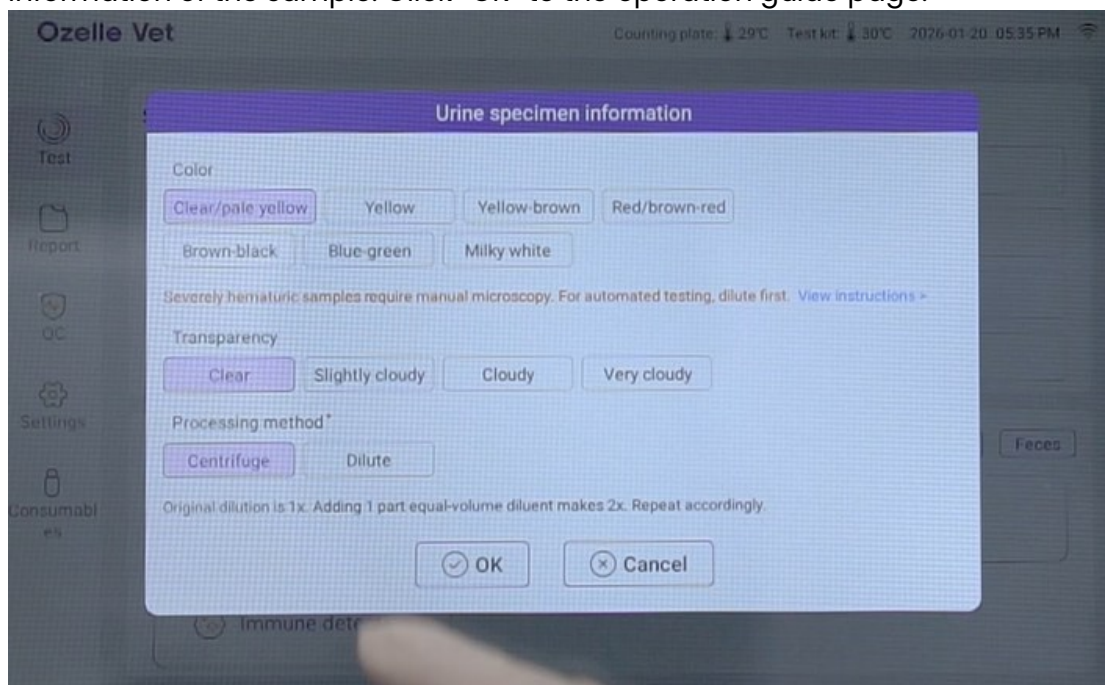

Assemble the required consumables according to the Operation Guide, and insert them into the instrument. Then click “Next” to the sample loading page.

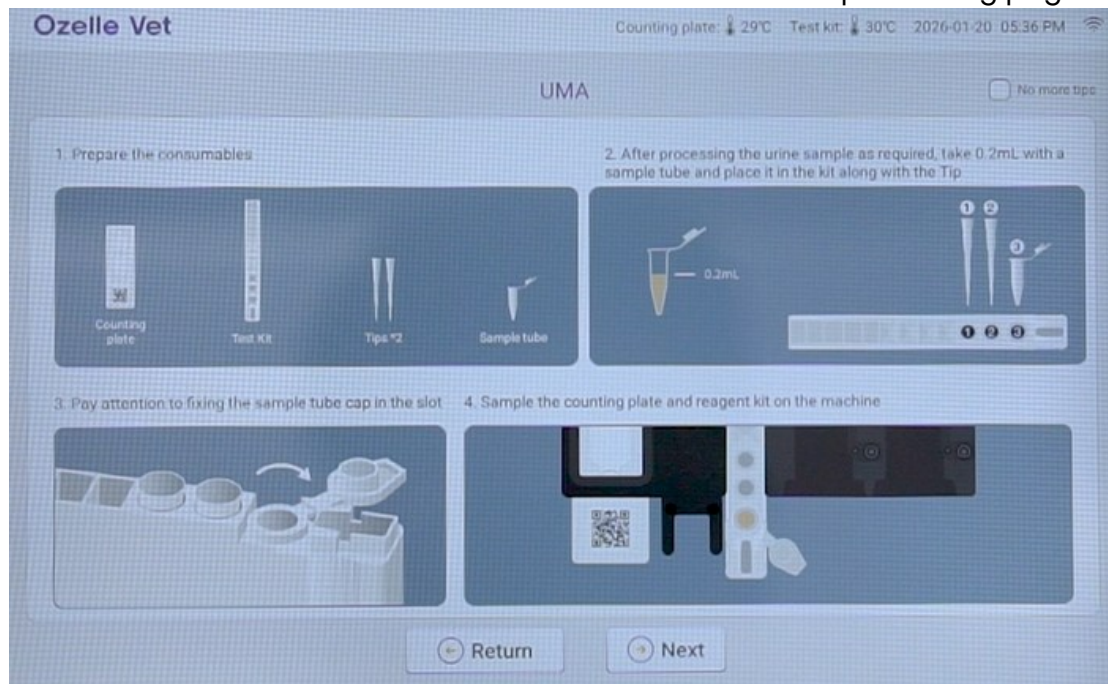

When the consumables are inserted correctly, the green check marks will appear on the screen.

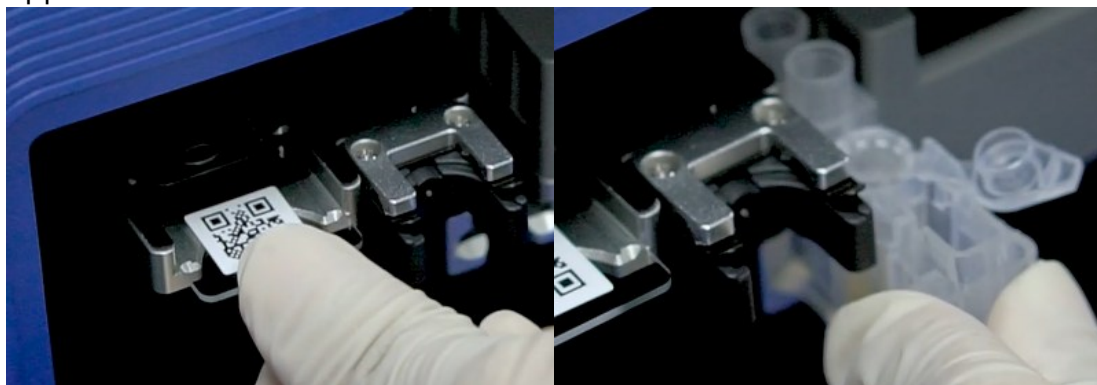

Then click “Slot-in”, the instrument will automatically complete the test.

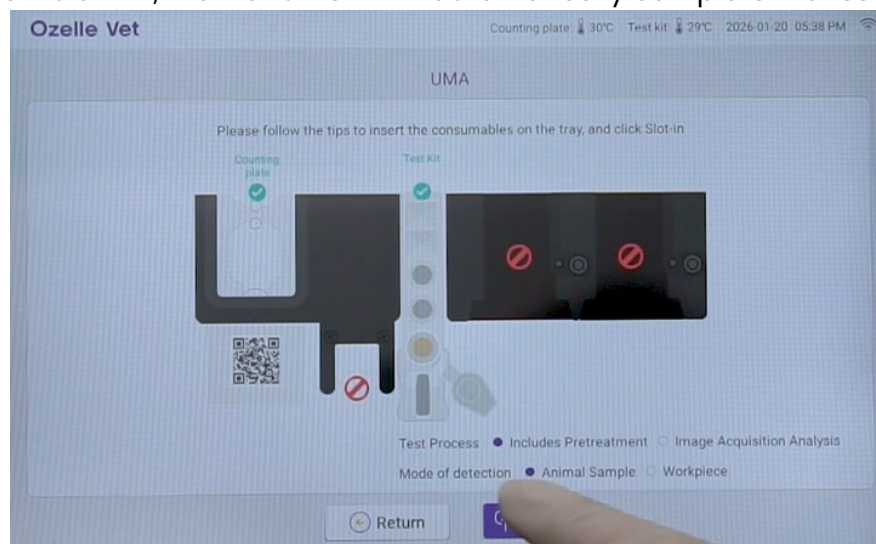

During the test, the instrument will display the real-time progress on the screen.



When the test is complete, the results will be displayed on the screen for viewing.

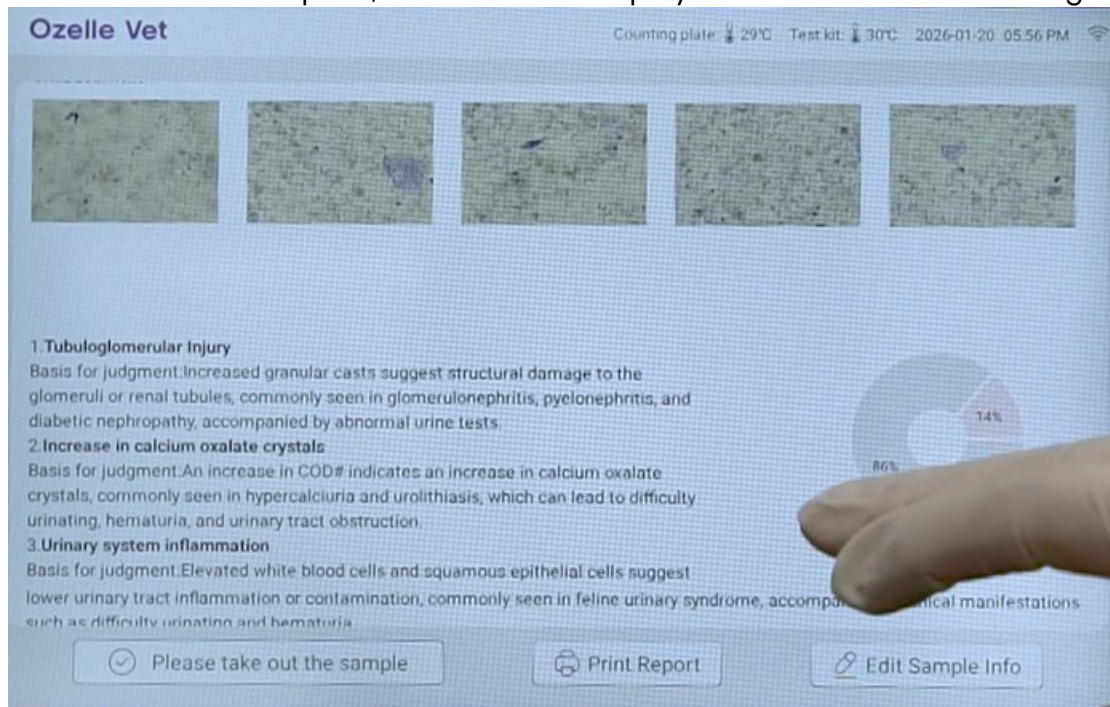

After the test, remove all consumables and discard them in the medical waste bin.

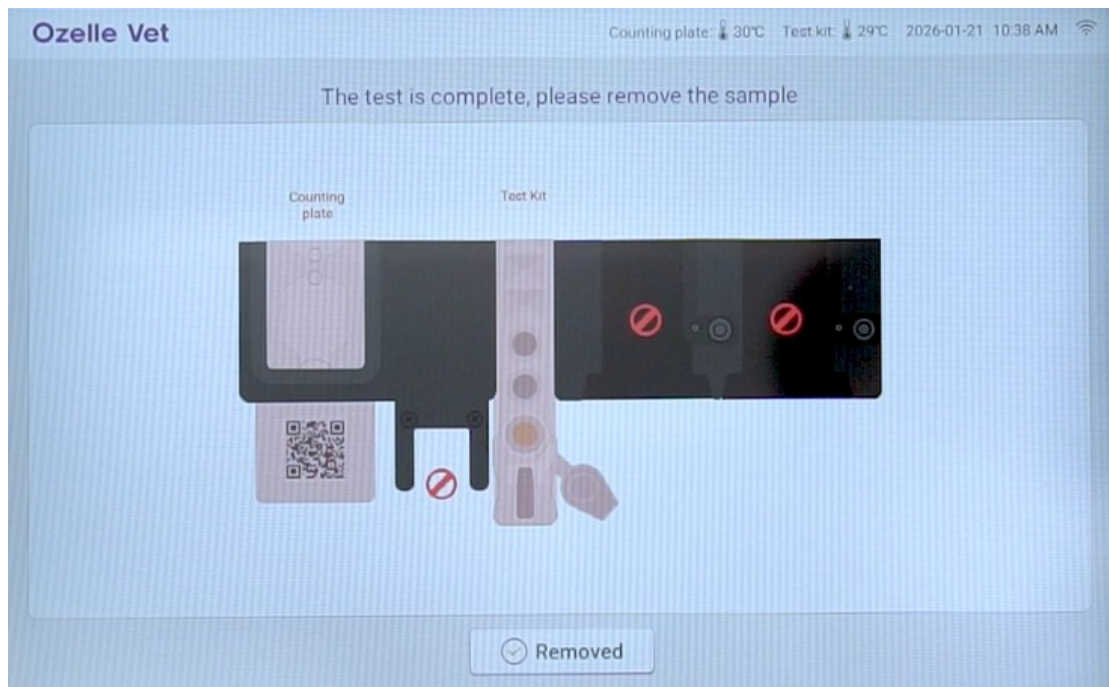

Click "Removed" to end the test.